

VENTILCONVETTORE Versione SP 200/1600
FAN COIL UNITS SP Version 200/1600

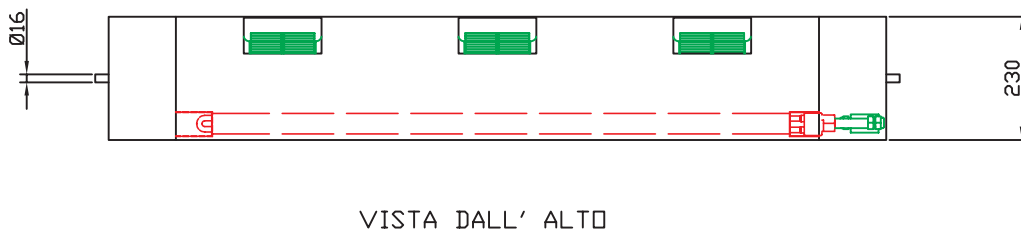
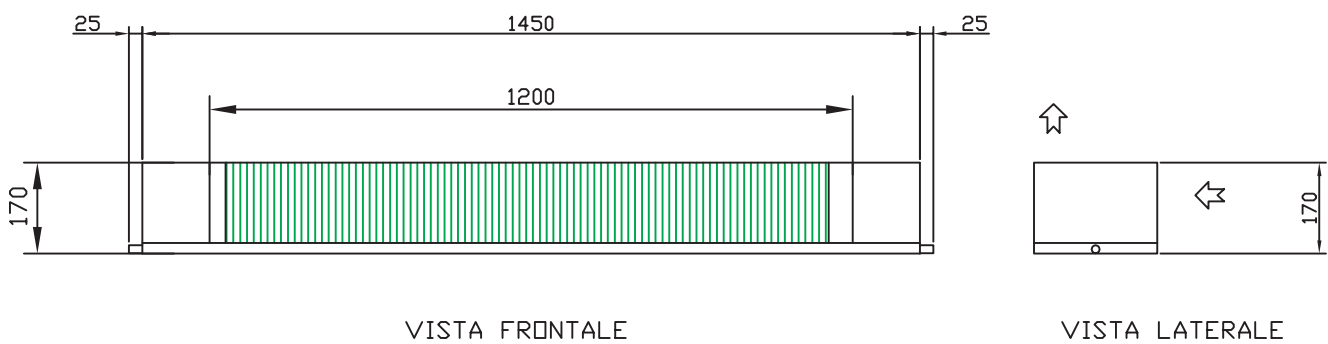

\varnothing Tubi scarico condensa = 15 mm
N.B. Entrata tubazioni idrauliche da stabilire

I dati pubblicati possono essere modificati senza preavviso.
The printed data could be modified without any notice.

DIMA VENTILCONVETTORE Versione SP 200/1600
FAN COIL UNITS SP Version 200/1600

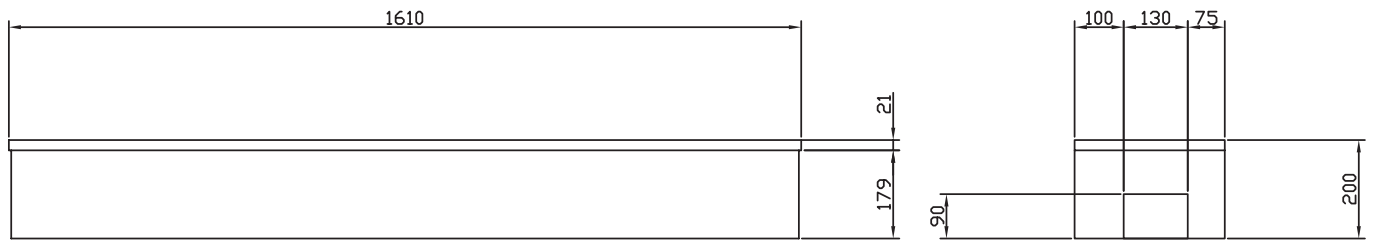

VISTA FRONTALE

VISTA LATERALE

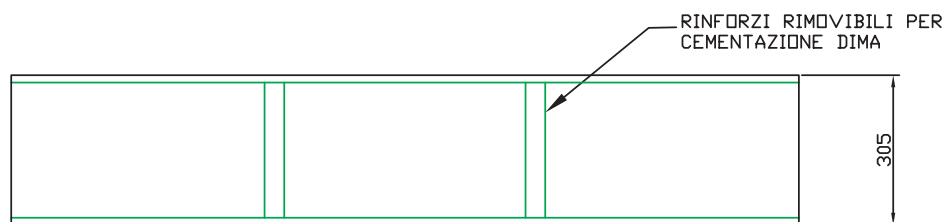
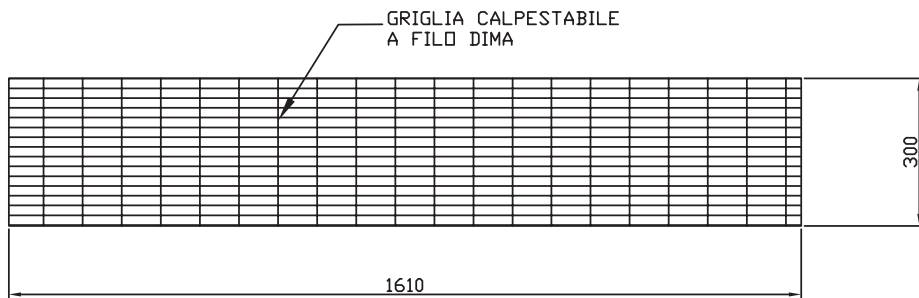

VISTA DALL' ALTO

Ø Tubi scarico condensa = 15 mm
N.B. Entrata tubazioni idrauliche da stabilire

I dati pubblicati possono essere modificati senza preavviso.
The printed data could be modified without any notice.